

Panel 1



Panel 2



Panel 3

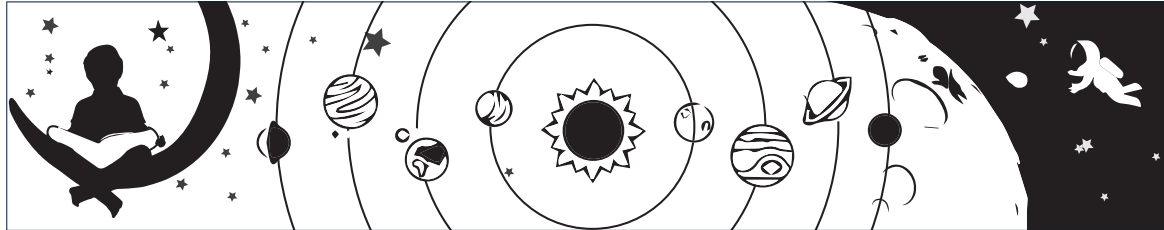

Panel 1

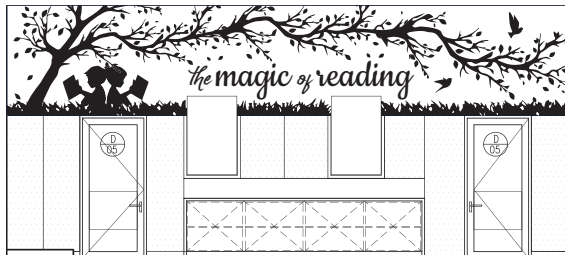

Panel 2

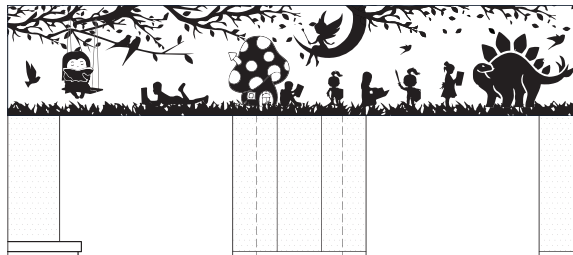

Panel 3

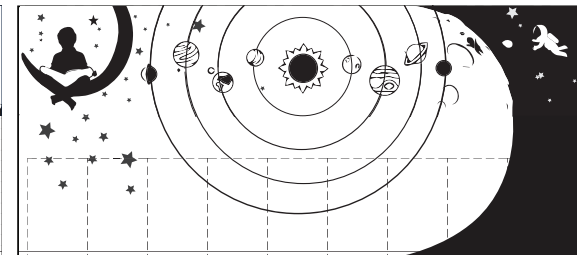

APPLIED
GRAPHIC
STRIP

HAND
PAINTED

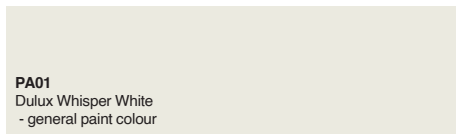
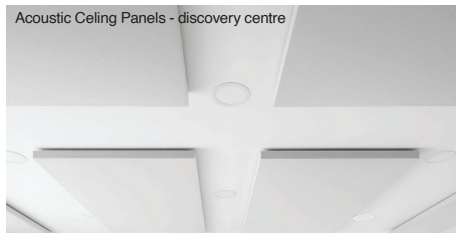

Existing furniture colours



Storytime chair concept



Perforated Plasterboard Ceiling
- staff resource & STEM Lab

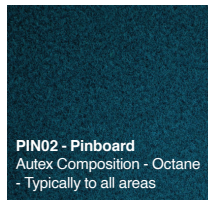
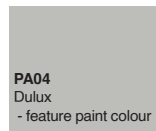
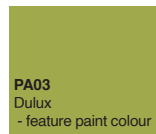
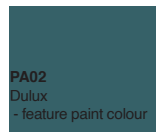

Wall Graphic concept - discovery centre



Wall Graphic concept - science & engineering lab

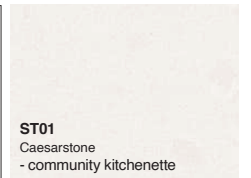
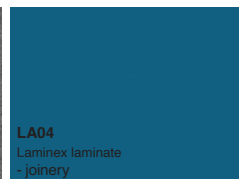
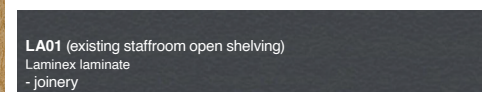
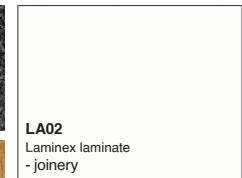
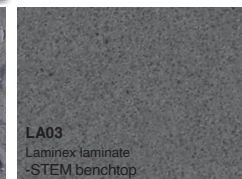
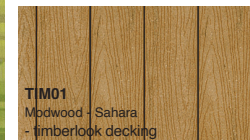
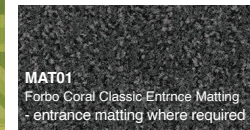
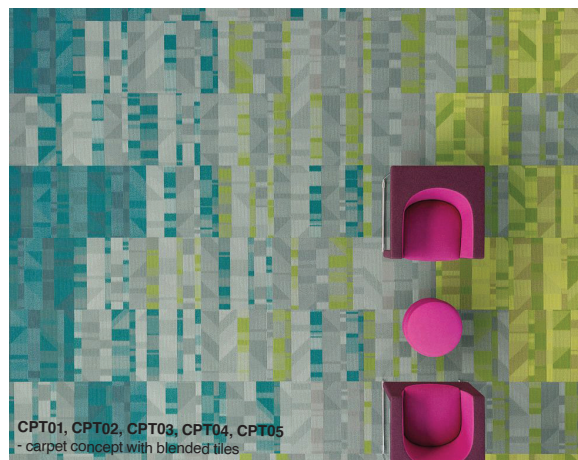
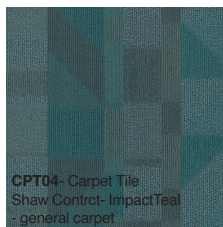
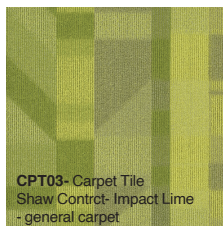
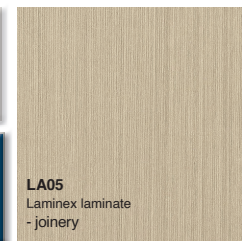
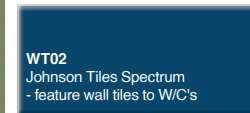
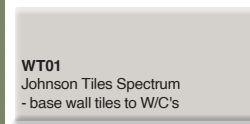



01

Community Gathering

- modular lounge combination of pieces
- VE Furniture - Elements Modular Lounge pg 74, 80 - 81



03

Library

- modular lounge ottomans
- VE Furniture - Elements Earth Hexagon pg 81



04

Library

- connecting ottomans
- VE Furniture - Flower Ottoman pg 100



06

Library

- task chair
- VE Furniture - Falcon pg 55



05

Library

- paperback spinners
- re-used existing



08

Library

- modular lounge, bookshelf, desk with stools
- VE Furniture - Habitat D1 pg 60



10

Library

- flexible modular tables & chairs
- VE - Tetris Tables



location for student use
ipads for book searching



02

Community Gathering

- mobile interstackable table & chairs
- VE Furniture - iFlip Linea Table pg 132
- VE Furniture - Agora Chair pg 36



12

13

Staff Resource Space

- multipurpose tables
- VE Furniture - iDisc Round Table pg 136
- VE Furniture - Agora Chair pg 36



11

STEM - Classroom

- multiple layout options
- VE Furniture - Link Shield Table pg 156
- VE Furniture - Flex Chairs pg 32

rug nom size:
2000mm dia



rug
nom size:
2000m x
3600mm

07

Library & STEM

- multiple rugs



09

Library

- storytime chair & side table
- VE Furniture - Ocean Double Chair
- VE Furniture - Rondo Ottoman

- existing joinery to be retained in its current location
 - existing joinery to be demolished & removed from site by builders
 - existing joinery to be retained & relocated
 - existing loose furniture
- (04) number corresponds with existing joinery / furniture that will be reused refer to DD07 & DD08 for proposed positions & existing images



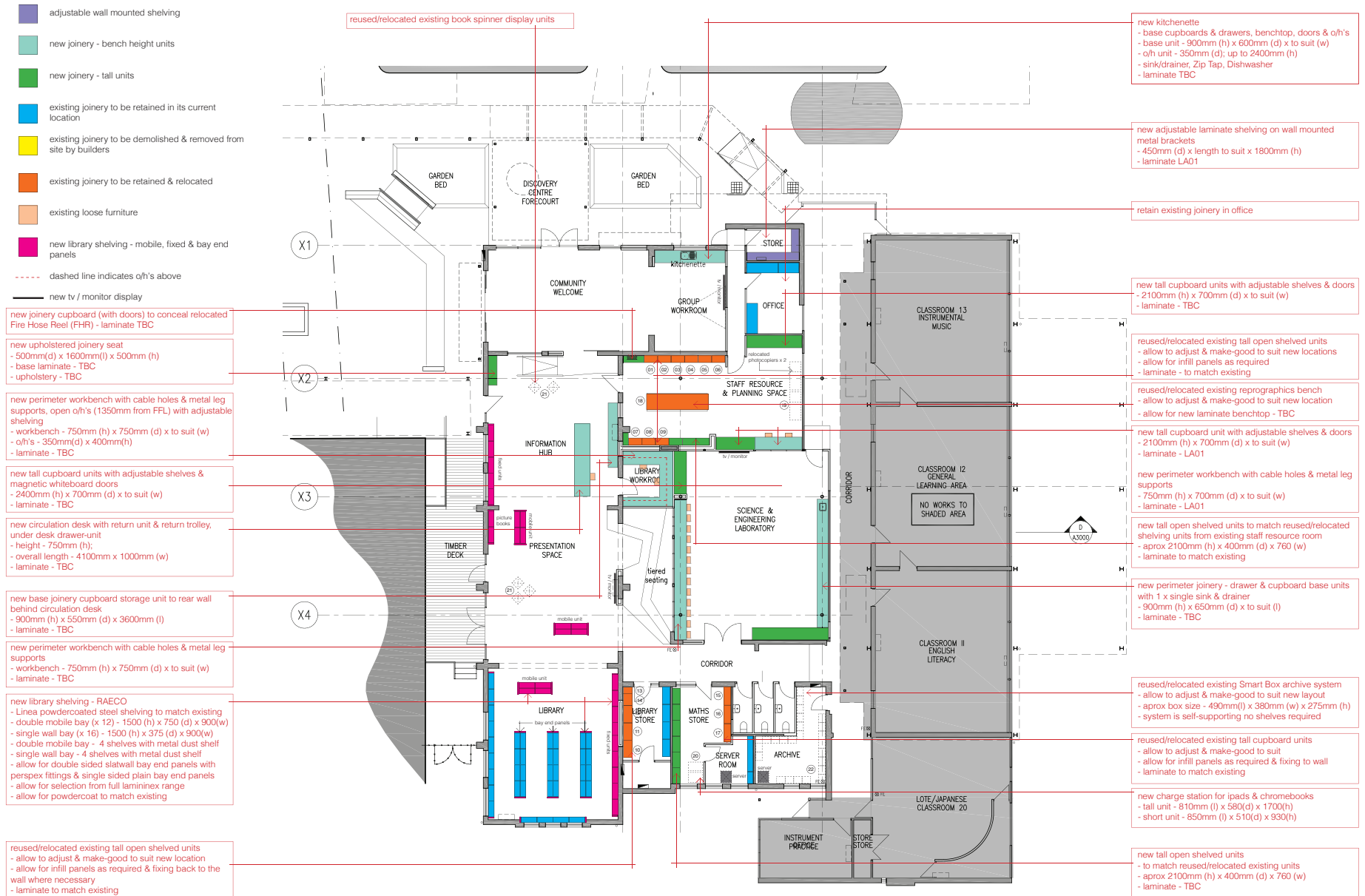

New Joinery & Reused Furniture

existing conditions



renovation/modernisation



Existing conditions and renovation / modernisation

existing conditions



renovation/modernisation



Existing conditions and renovation / modernisation

existing conditions



renovation/modernisation



Existing conditions and renovation / modernisation

existing conditions



renovation/modernisation



Existing conditions and renovation / modernisation



- Cr Georgina Oxley, City of Kingston Longbeach Ward · Follow
- Looks awesome OLA Team. Very different to when I was at OLA 15 years ago! A great space for the wonderful OLA students!
- 1y Like Reply
- Rachael Martin
- Looks fabulous! It was great to see the kids so excited 😊 about it.
- 1y Like Reply
- Kara Bogicevic
- The kids were so excited yesterday to share their highlights after their first visit to the new buildings; Library & Read-to-Self area got the 🙌🙌
- 1y Like Reply
- Gillian Katherine
- Well Done! It's awesome.
- 1y Like Reply
- Joanne Wade
- Looks fantastic.
- 1y Like Reply
- Olivia Moran
- Looks awesome!!
- 1y Like Reply
- Write a comment...

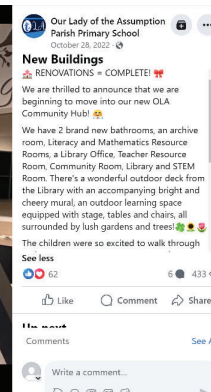
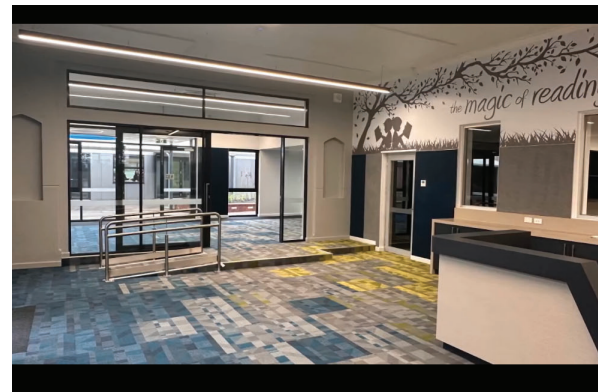

Social Media & Promotional Material



The Community Hub logo is an extract from the student mural: "Three Friends", symbolising friendship, kindness, and diversity.

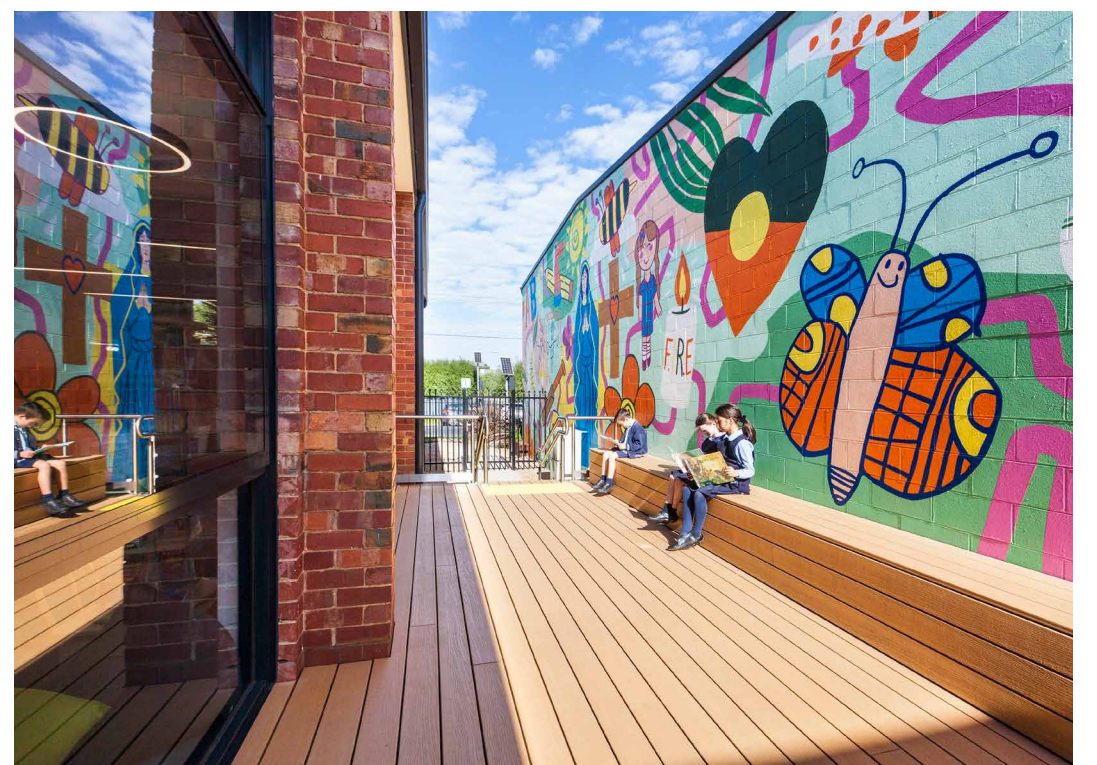

OUR LADY OF THE ASSUMPTION PARISH PRIMARY SCHOOL

The new Community Hub at Our Lady of the Assumption Primary School in Cheltenham, Victoria, reimagines existing spaces, striving to live out the school's Vision to be a place of welcome, with pride in creating a wonderful community spirit. The success of the new building allows each member of the learning community to feel a strong sense of belonging at the heart of the school.

The newly formed community room, expanded library, and STEM Centre combine to support the school's philosophy of fostering the skills and talents of all students, bringing families into partnership with their children in the learning process. The enlarged library space improves the functionality and quality of the learning facilities for students and families to share and reinforce the school's 'love of reading'.

The reclaiming of a narrow strip of outdoor found space between the library and the adjacent multi-purpose hall provides an extension of the library, and a place for quiet reading and reflection. The mural presented is a celebration of OLA Cheltenham focussing on the strong connection between education, community values, and Catholic identity. The design is a collaboration of images drawn by the children and the artist. The image is vibrant and fun whilst adorning a calm green background that ties into the colour scheme of the new building. The red line running through the piece links the images representing the interconnectedness and unity within the school community.

